

PLASTIC FRAME-FIXING DOWEL

41



WE 10, R 10
Multiple attachment of facade cladding: Concrete and solid bricks

WD 10
Multiple attachment of facade cladding: Perforated bricks

WE 10 with countersunk screw:
 Galvanized steel with hexagon screw:
 Galvanized steel, A4 stainless steel

R 10 with countersunk screw:
 Galvanized steel

WD 10 without screw

Proof of performance

1. Areas of use

- The anchor may be used for multiple attachment with facade cladding
- WE 10** may be anchored in the following anchoring bases:

Standard concrete

Masonry walls (solid bricks, solid sand-lime bricks)

Weather cladding of triple-layer exterior wall panels made of standard concrete

- R 10** may be anchored in the following anchoring bases:

Standard concrete

Masonry walls (solid bricks, solid sand-lime bricks)

- WD 10** may be anchored in the following anchoring bases:

Masonry walls (solid sand-lime bricks, vertically perforated bricks, hollow blocks of lightweight concrete, solid bricks and solid blocks of lightweight concrete, no-fines lightweight concrete (TGL))

Weather cladding of triple-layer exterior wall panels made of standard concrete

- Installation temperature: Temperature in anchoring base $\geq 0^{\circ}\text{C}$
- The stainless-steel screw may be used outdoors and in industrial atmospheres and near the sea
- The galvanized screw may be used outdoors and in industrial atmospheres and near the sea if the area near the screw head is protected against moisture so that penetration of moisture into the anchor shaft is not possible (suitable paint or plastic caps).

Important information for experts:

- Use rotary drilling for perforated and hollow blocks (without impact mechanism).
- Drilling dust must be removed from the drill hole.
- For anchoring in solid brick and solid sand-lime brick, we recommend that you perform pull-out tests due to the differences in brick manufacturing.

- Suitable for the attachment of facade substructures (made of wood or steel), wood beams, wood laths, metal rails, angle brackets, profiles etc.

2. Advantages

- Pass-through mounting
- Can be loaded immediately - no waiting
- Anchor sleeve and screw are optimally matched
- The knock-in lock prevents premature spreading of the anchor during installation

3. Properties

- Anchoring via friction engaging between anchor sleeve and anchor surface
- The anchor sleeve is made of high-quality polyamide

Setting instructions

WE 10, R 10 concrete and solid brick:

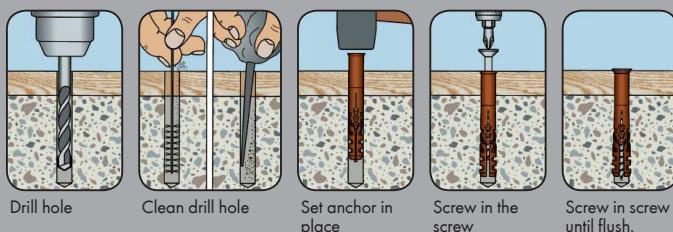

WD 10 perforated brick:

