

AMO[®]-Y SCREW DIA. 11.5 mm

55.4

Steel, special coating, silver

Recommended by

YTONG

for window installation



<p>Performance facts</p>	<p>Guidelines for planning and carrying out window and front door installation, 2010 edition Art. No.: 5995 000 000</p>	<p>Window walls in accordance with previous DIN 18056 or elements with an area over 9 m² and safety barrier glazing in accordance with the German TRAV or DIN 18008-4</p>
<p>Test reports Component testing with AMO[®]-Y 11.5 mm Frame Screw for attaching a plastic window door to the building without lateral support and spacer blocks in aerated concrete masonry of type PP 1.6 - 0.30. Test report No. 11-002642-PR01 from May 25th, 2012</p>	<p>The attachment must safely transfer all planned forces affecting the window to the building and the subsoil. The loads, comprised of the load of the window, the wind load and the payload, for example, must be determined (see DIN 1055) for this reason. In accordance with the respective applicable building regulations, buildings and their components must be planned in such a way that the life and health of people are not endangered and public safety is not impaired. Attachment of the windows must also comply with this criterion.</p>	<p>DIN 18056 applied for window walls with a surface of at least 9 m² and a side length of the shortest side of at least 2 m. In this area of application, anchors with construction/European technical approval or approval in individual cases are to be used. Anchors with construction/European technical approval or approval in individual cases are to be used for the attachment of safety barrier glazing in accordance with the German TRAV or DIN 18008-4</p>

1. Applications

- Tension-free spaced mounting for all frame materials for anchoring in aerated concrete
- Installation of window and door frames with 10 mm dia. pre-drilled mounting hole

2. Advantages

- Saves time – no anchor required
- Short installation times, as no setting tools are required
- Thanks to AW[®] drive, longer bit service life, improved force transmission, and no ejection forces
- Through-bolt installation
- Can be dismantled

- Virtually no spreading forces when setting
- Can be loaded immediately – no wait time after setting

3. Features

- Spreading-pressure-free, positive locking and removable anchoring
- Function of load pick-up is retained even under thermal loading

Note: Proper installation of the components must be checked while taking the respective local building situation (e.g. window sash weight, surface properties) into account. The attachment of safety barrier glazing in accordance with the German TRAV or DIN 18008-4 may only be carried out with the AMO[®]-Y Screw if corresponding approval is available for the individual case before the start of installation.

Setting instructions

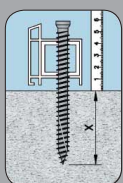

Align and affix the window frame

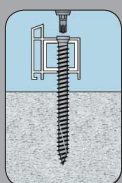

Screw in screw

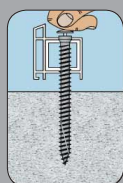

Press on cover cap

Important:

- Pre-drilling of window frame with 10.2 mm.
- No pre-drilling in aerated concrete, AMO[®]-Y screw must be screwed directly into aerated concrete.
- Align window frames with alignment clamps or AMO[®] Bag.
- Screw length = frame width + distance + screw-in depth