

WG-FIX SCREW ANCHOR

70

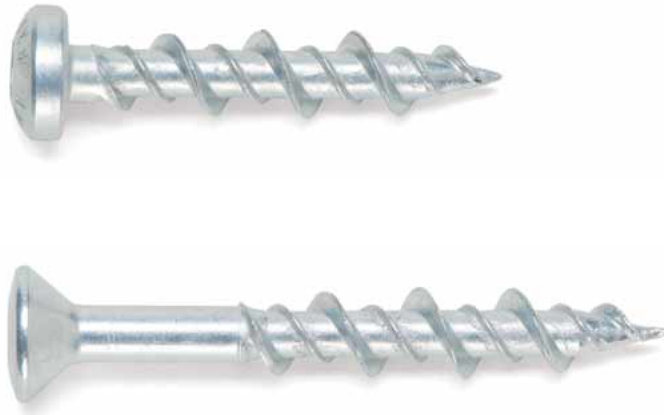

For fastening curtain rails, baseboards, picture frames, bathroom and kitchen accessories, etc.

- Fast, simple installation.
- Thanks to AW® drive, longer bit service life, improved force transmission, and no ejection forces.
- Two head versions – raised countersunk head for easy, clean countersinking and panhead for large-area contact.
- Universal anchorless screw connection – even on various surfaces, e.g. solid sand-lime brick, clay brick and gypsum plasterboard.
- HiLo thread provides for increased over-turning torque.
- High thread pitch enables fast screw-in speed.

Proof of performance

Applications:

Universal screw anchor for easy, secondary fastenings.

Materials to be processed:

Suitable for use in clay brick, solid sand-lime brick and gypsum plasterboard.

Notes:

Screw in high extra load, low speed and torque limiter. As soon as screw makes firm contact, do not screw in further.

Screw screw into gypsum plasterboard without predrilling.

Additional articles:

Bit AW®20

Art. No. 0614 100 220

Setting instructions

Surface: Solid stone

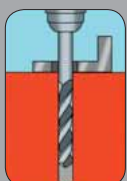

Produce drilled hole

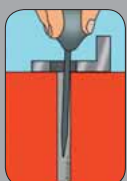

Clean drilled hole

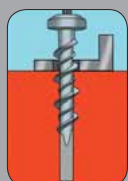

Screw in screw anchor

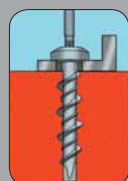

As soon as screw anchor makes firm contact, do not screw in further

Surface: Gypsum plasterboard



Screw in screw anchor

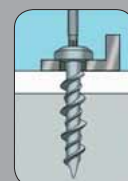

As soon as screw anchor makes firm contact, do not screw in further