

W-ID INSULATING ANCHOR

74.1



Length 50, PE white

Length 95, PE white

Setting tool for W-ID 50

Setting tool for W-ID 95

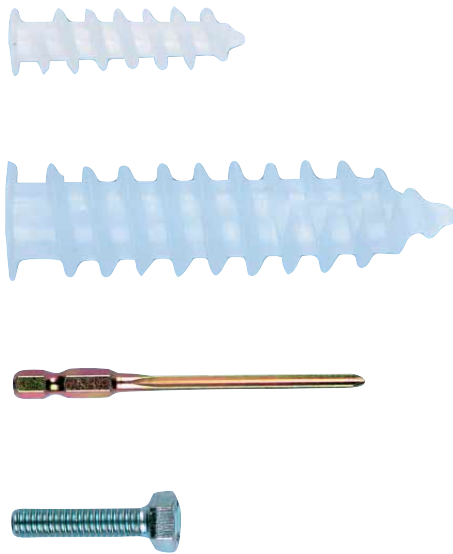

Proof of performance

1. Applications

- For fastening light loads in hard foam panels (e.g. outside wall with thermal-insulation composite system)
- For fastening components in conjunction with wood screws, particle board screws (without drilling tip, counterthread or ring thread) and metric screws
- Outside or in rooms subject to moisture in conjunction with a stainless-steel screw
- Fastening building signs, lighting, alarm systems etc., for use in refrigeration/

air-conditioning construction, insulation, prefabricated house construction, facade construction, electrical installations etc.

- W-ID Set A2 (stainless steel A2) may be used outdoors or in damp rooms. The cover rosette must then be sealed off with silicone to prevent the penetration of water

- No heat bridges are created
- W-ID set is delivered preassembled
- The "W-ID set" screw can be loosened again (screw can be turned back again for alignment)

2. Advantages

- No complicated spaced assembly for small fastening tasks
- The setting tool for the W-ID 50 fits in the 1/4" bit holder; an M 8 x 30 hexagon bolt is included for the W-ID 95
- With the W-ID 95 the screw diameter 8 can be reduced to the screw diameter 4-5 with the nylon anchor Art. No. 0903 8 40
- Fast, economical fastening
- Can be installed with a battery-operated screwdriver; hand installation also possible

3. Features

- High-quality polyethylene
- Temperature-neutral from -20°C to +100°C
- Form-fitting fastening
- Suitable for cotter-pin mounting
- Resistant to rotting, weathering and aging

Setting Instructions I

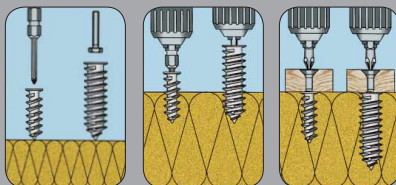

Position anchor and install with included setting tool

Screw in anchor without predrilling.

Secure part

Setting Instructions II

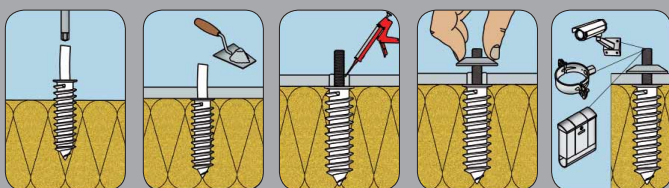

Screw in anchor without predrilling.

Apply layer of plaster and remove protective cap after it has dried

Fill hollow space between plaster and stud screw with silicone

Screw on cover rosette

Fasten attached part

Setting Instructions III

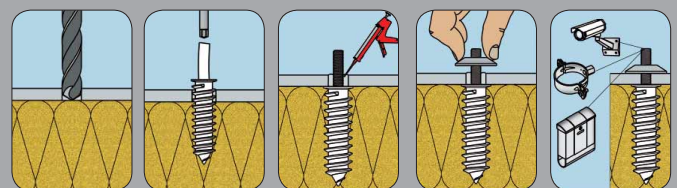

Predrill plaster up to insulation layer

Screw anchor into predrilled hole and remove protective cap

Fill hollow space between plaster and stud screw with silicone

Screw on cover rosette

Fasten attached part