

62

Spring-Loaded Anchor

Type W-FK

with washer and MS knurled nut

Type W-FKH

With washer, nut and hook

Type W-FKW

with centering plug, collar sleeve made of polyamide (nylon) and hexagon nut M10

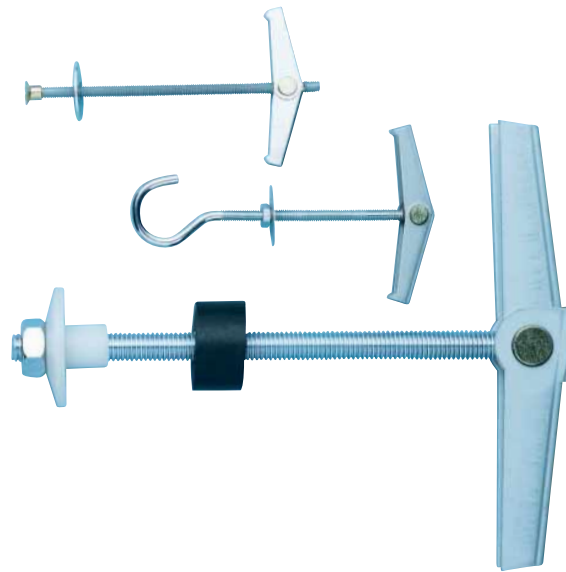

Proof of performance

1. Applications

- Type W-FK: The anchor for attaching curtain rails, shelving rails, switches and lightweight add-on pieces
- Type W-FKH: For the attachment of lamps, hanging baskets, ceiling decorations, information signs etc.
- Type W-FKW: For the attachment of wash basins, hanging toilets, boilers, urinals, support structures etc. to hollow walls, supply shafts. The centering plug is used to fill up the drill hole and to center the threaded rod

2. Advantages

- The spring-loaded anchor opens up on its own in each position due to the force of its spring
- Spring-loaded anchors require less hollow-space depth than tilting anchors due to their structure

3. Properties

- Steel, galv.
- Fully premounted
- Turn-prevention mechanism (claws) keeps prevents turning during installation
- Strong hold due to its distribution of the load over large area

Setting instructions

Type W-FK

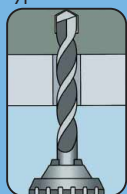

Drill hole

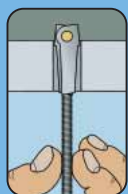

Insert the anchor until the hooks fold open

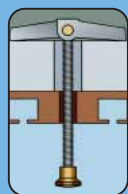

Attach component and screw on brass nut



Screw in screw until flush

Type W-FKW

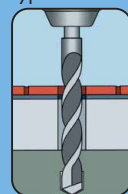

Drill hole

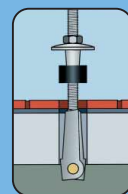

Insert the anchor until the hooks fold open

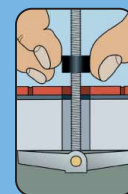

Attach centering plug

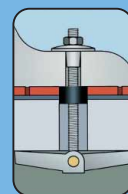

Mount component