

64

## Plastic Hollow-Wall Anchor W-KH



### Efficiency Statement

#### 1. Areas of application

- For attachments in plates and boards up to 19 mm thick
- For attachment of lightweight rails, sheets, boards, etc.

#### 2. Advantages

- The rotation prevention mechanism on the collar prevents the sleeve from turning in the drilled hole (assuming that the drilled hole diameter is appropriate)
- The anchor expands in the cavity by itself, thus no setting tool is required
- The anchor can also be used in solid anchorage materials

#### 3. Characteristics

- High-quality polyamide (Nylon)
- For use with a wood screw (Wüpfast) Ø 4-5 mm
- Make sure that the screw is not over-tightened (risk of breakage)
- Tighten screw by hand – Do not use a cordless screw driver

### Installation

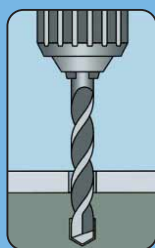

Drill hole

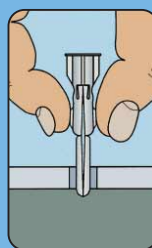

Insert anchor

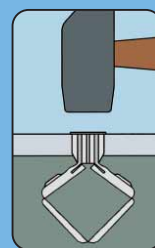

Gently hammer in anchor until flush

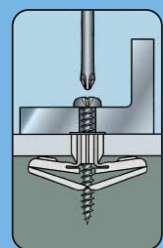

Tighten screw using a screwdriver