

# NAIL ANCHOR W-NA-M

35.1



## Multiple attachment of non-load-bearing systems:

Cracked and uncracked concrete

## W-NA-M (with stepped thread)

Galvanized steel

### Proof of performance

Approvals		
<b>European Technical Approval</b> Multiple attachment of non-load-bearing systems in concrete	<b>Fire resistance</b> <b>Technical Report TR 020</b> <b>R30 - R120</b>	

### Good to know:

The nail anchor combines the advantages of an anchor bolt with simple installation, since the nail anchor is just knocked into the bore hole.

The nail anchor may be used in reinforced or non-reinforced standard concrete from minimum strength class C12/15 to maximum C50/60.

With the corresponding approval, the nail anchor W-NA-M meets the requirements of the directives for sprinkler systems, planning and installation, VdS CEA 4001: 2010-11 (04).

## 1. Applications

- **Multiple attachment of non-load-bearing systems:** Anchoring with European Technical Approval in cracked concrete (concrete tensile zone) and in uncracked concrete (concrete pressure zone)
- Suitable for securing: light ceiling coverings and joist constructions, pipelines, wire suspension brackets etc.
- With European Technical Approval, the anchor may be used in reinforced or non-reinforced standard concrete of a strength class of C12/15 minimum and C50/60 maximum in accordance with EN 206-1:2000-12.
- W-NA-M (galvanized steel) may only be used under the conditions of dry interior rooms.

## 2. Advantages

- Quick and simple installation
- Pass-through mounting
- Not much drilling required, thanks to a reduced anchoring depth of 25 mm
- Small edge clearances and axle bases possible
- Easy setting: Just knock it in

- No special drilling or setting tools required
- W-NA-M: M8 can also be used as M10 threaded rods, thanks to stepped thread

## 3. Features

- Load-controlled expanding peg: Expansion from the application of load
- Approval: **Multiple attachment of non-load-bearing systems in concrete:** European Technical Approval ETA-11/0339
- Fire resistance: **R30, R60, R90, R120** (anchorage base concrete C20/25 up to C50/60): Technical Report TR 020 "Evaluation of Anchorage in Concrete with Regard to Fire Resistance" (contained in ETA-11/0339)

### Setting instructions

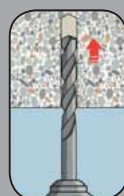

Drill the hole



Clean the drilled hole

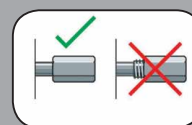

Check the position of the sleeve

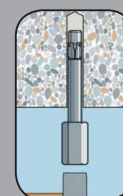

Push the W-NA-M into the drilled hole and knock it in

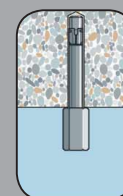

Knock in the W-NA-M until it is flush