

LED MULTI-CHAMBER LAMPS FOR TRACTORS AND TRAILERS

5-CHAMBER LAMP

**Universal
LED model
ADR-tested**

- Modular LED tail lamp with 5 LED functions: Tail lamp, brake lamp, turn signal lamp, reversing lamp and rear fog lamp
- All LED lamps are available individually and can be exchanged quickly and easily
- Housing color: anthracite. Additional colors available for replacement (see individual lamp components)
- Can only be used with 24 V
- Protection type: IP67
- Output: 11.4 W
- Incl. 2 x M8 for mounting
- **Connection:** with connection cable, length: 2.0 m

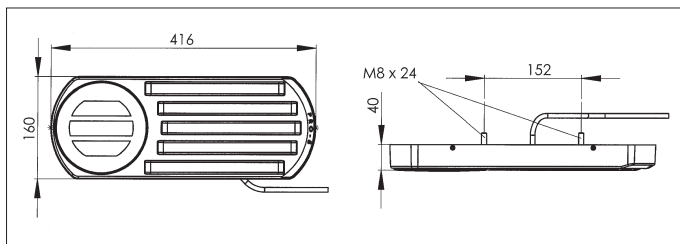

Accessories			
Designation	Number required per lamp	Art. No.	P. Qty.
LCG LED Monitor	1	0812 46 030	1
LED Monitor, turn signal, 24 V	1	0812 46 041	1
LED Monitor, tail lamp, 24 V	1	0812 46 050	1

Individual lamp parts			
Designation	Number required per lamp	Art. No.	P. Qty.
LED Brake/Tail Lamp XL	1	0812 46 141	1
LED Turn Signal Lamp XL	1	0812 46 143	1
LED Rear Fog Lamp XL	1	0812 42 470	1
LED Reversing Lamp XL	1	0812 46 142	1
LED Rear Fog Lamp XL	1	0812 46 140	1
Triangular Reflector, round	1	0812 40 110	1
Exchangeable Housing, anthracite	1	0812 46 280	1
Exchangeable Housing, silver-gray	1	0812 46 281	1
Exchangeable Housing, red	1	0812 46 282	1
Exchangeable Housing, white	1	0812 46 283	1

Functions					Left	Right	License plate lamp	Side marker lamp	LED module permissible	Art. No.	P. Qty.
Turn signal, brake, tail lamp	Reversing lamp	Rear fog lamp	Clearance lamp	Reflector							
•	•	•		•	•					0812 46 290	1
•	•	•		•		•				0812 46 291	1