

Fittings for Central Lubrication Unit

- All screw-in threads are tapered and thus self-sealing.
- Size of screw-in thread depends on lubrication point/manifold point.
- All fittings for 4 mm and 6 mm pipe diameters are suitable for use in the low-pressure range only.

Cutting-Ring Fittings

Angled Screw-In Connectors

- For the connection of a line to a lubrication point or divider manifold point.
- Material: steel.
- Galvanized surface.

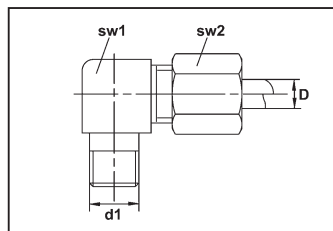

Complete Fitting

D	d1	Size1	Size1 2	Art. No.	P. Qty.
4	M 6x1 tap.	9	10	0884 604 101	10
4	M 8x1 tap.	9	10	0884 604 102	
4	M10x1 tap.	9	10	0884 604 103	
4	R 1/8" tap.	9	10	0884 604 104	
6	M 6x1 tap.	11	12	0884 606 101	
6	M 8x1 tap.	11	12	0884 606 102	
6	M10x1 tap.	11	12	0884 606 103	
6	R 1/8" tap.	11	12	0884 606 104	

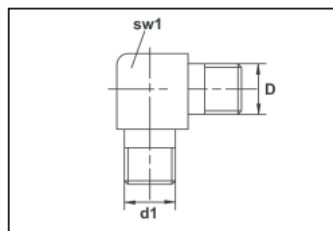

Individual Connector

D	d1	Size	Art. No.	P. Qty.
4	6x1 tap.	9	0884 604 131	10
4	8x1 tap.	9	0884 604 132	
4	10x1 tap.	9	0884 604 133	
6	6x1 tap.	11	0884 606 131	
6	8x1 tap.	11	0884 606 132	
6	10x1 tap.	11	0884 606 133	

Straight Screw-In Connectors

- For the connection of a line to a lubrication or divider manifold point.
- Material: steel.
- Galvanized surface.

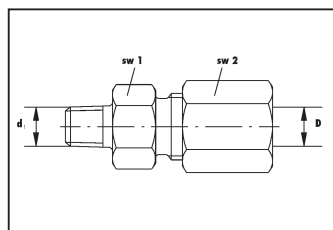

Complete Fitting

D	d1	Size1 1	Size1 2	Art. No.	P. Qty.
4	M 6x1 tap.	9	10	0884 604 001	10
4	M 8x1 tap.	10	10	0884 604 002	
4	M10x1 tap.	11	10	0884 604 003	
4	R 1/8" tap.	11	10	0884 604 004	
6	M 6x1 tap.	11	12	0884 606 001	
6	M 8x1 tap.	11	12	0884 606 002	
6	M10x1 tap.	11	12	0884 606 003	
6	R 1/8" tap.	11	12	0884 606 004	

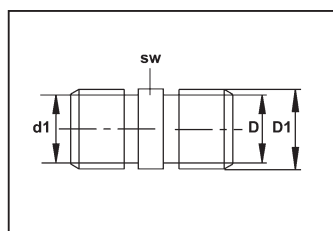

Individual Connector

D	d1	Size	Art. No.	P. Qty.
4	6x1 tap.	9	0884 604 031	10
4	8x1 tap.	10	0884 604 032	
4	10x1 tap.	11	0884 604 033	
6	6x1 tap.	11	0884 606 031	
6	8x1 tap.	11	0884 606 032	
6	10x1 tap.	11	0884 606 033	