

# GENERAL NOTES ON APPLICATION OF SEALING MATERIALS

## 1. Cleaning of the foundation:

The foundation must be clean, dry and free of grease and dust. Remove any residual material, such as oil, grease, rust, or water before using the sealant. Exceptions are listed in the technical information leaflet.

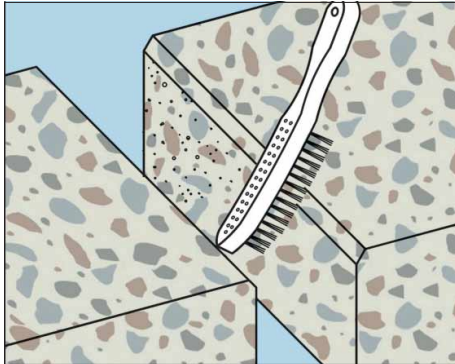

## 2. Prevention of three-point adhesion:

During process, the sealant must only be subject to 2-side adhesion. Any additional adhesion to an undersurface can result in stress cracks in case of movement so that a sealing of the gap is no longer guaranteed. To avoid three-point adhesion, PE backfill material should be put into the gap.

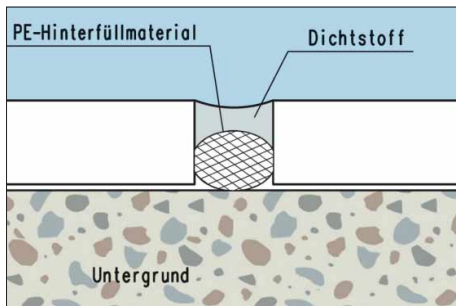

## 3. Gap dimensioning:

The gap should be about half as deep as it is wide. In case of narrow gaps, however, the depth should be at least 6 mm. PE backfill material should be used to limit the gap depth.

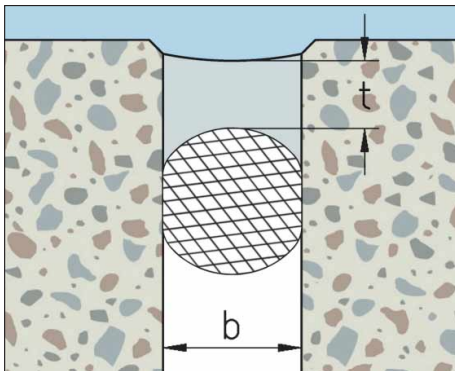

## 4. Primer:

In case of certain foundations, the use of a primer is necessary to guarantee a secure adhesion of the sealant (see the "Compatibility of Würth Sealants with Building Materials" table or the technical information leaflet).

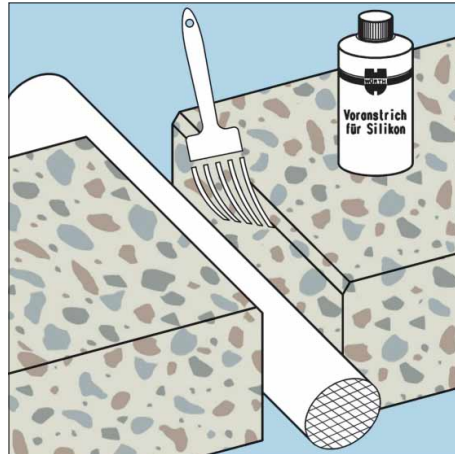

## 5. Use of sealant smoothing agent:

Through spraying with sealant smoothing agent and the subsequent removal, an optically clean and smooth surface and complete coverage by spraying is guaranteed. The selection of the right sealant smoothing agent is important (see the "Würth Sealants - Properties and Applications" table or the technical information leaflet) to avoid changes in color of the sealant.

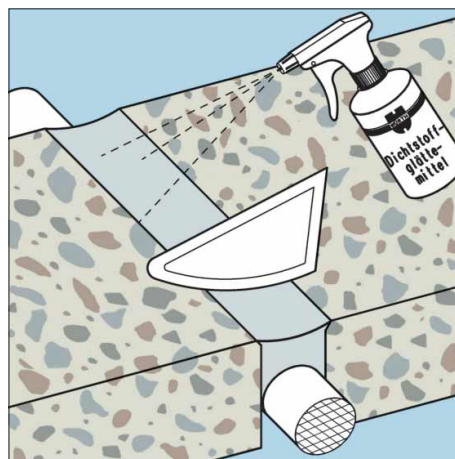

This information is only a recommendation based on our experience. Preliminary testing required.

### ← Optimal gap dimensioning

Narrow gaps $b < 12$ mm:	Gap depth $t = 6$ mm
Wide gaps $b > 12$ mm:	Gap depth $t = 1/2$ gap width $b$
Minimum gap width $b$ :	6 mm
Maximum gap width $b$ :	20 mm

## 6. Compatibility with paint:

Sealants that have good adhesion and compatibility with a paint and that can be painted over in the edge area with 1 mm are considered to be compatible with paint (see the "Compatibility of Würth Sealants with Building Materials" table or the technical information leaflet). The paint on the foundation must be completely set so that safe adhesion and good compatibility can be achieved. Due to the number of lacquers and paints on the market, we recommend that you perform a preliminary test.

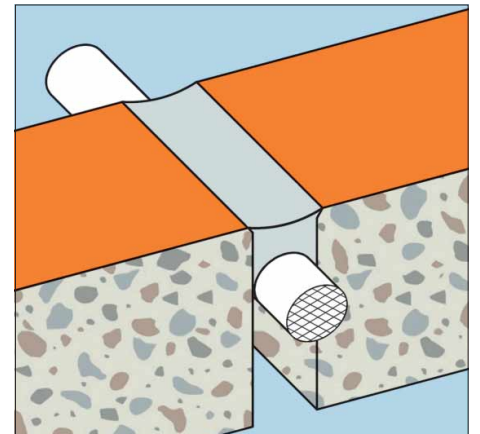

## 7. Can be painted over:

Sealants that can be painted over are those that can be painted or lacquered over later (see the "Compatibility of Würth Sealants with Building Materials" table or the technical information leaflet). The sealant must be completely hardened with painted/lacquered over. Due to the number of lacquers and paints on the market, we recommend that you perform a preliminary test. Expansion gaps should basically not be painted over because the topcoat and the sealant may crack. Leakage is the result.

