

INSTRUCTIONS FOR KEEPER CONVERSION

Usage information for multiple locks

Technical information:

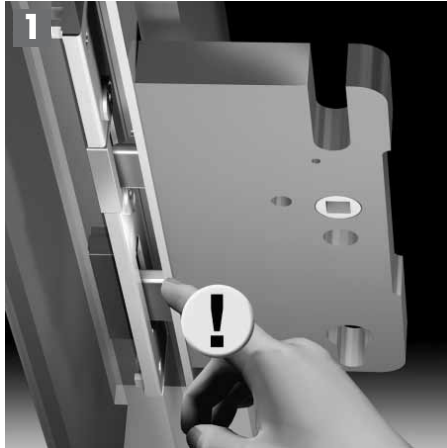

1 Construct door with the specified axial dimension to ensure trouble-free functioning of the locks at all times.

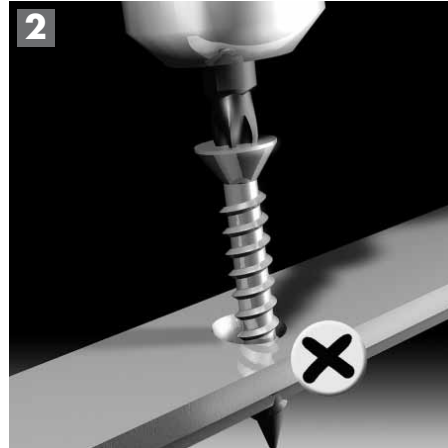

2 Screw in screws straight to create tension.



3 The door leaf may not be drilled through near the lock when the lock is installed (e.g. for protective fittings).



4 Install cylinder without tension and align it 90° to the door leaf.



5 Mount backplates and rosettes without tension.

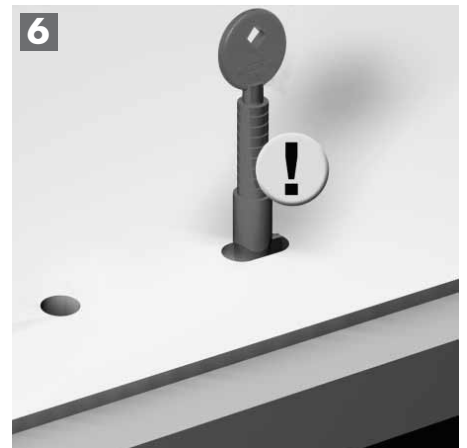

6 If the original cylinder is not installed, only lock/unlock the door with the Würth cylinder-measuring wrench.

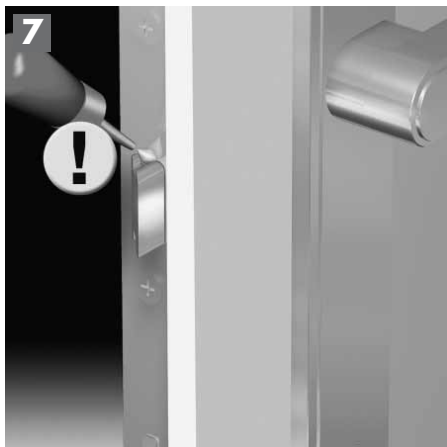

7 Lubricate locking points (keeper, bar, additional lock) at least once a year.



8 Do not paint over lock or locking elements (bar, keeper etc.).

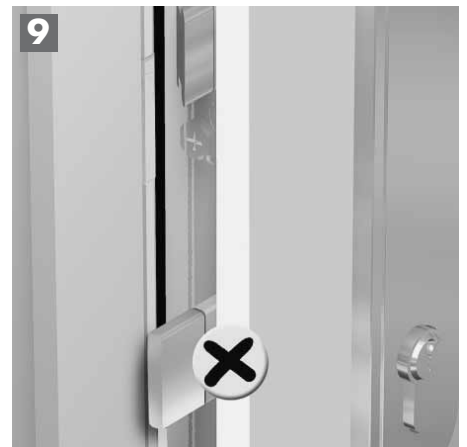

9 Do not lock the locks when the door is open and then push their elements against the frame.