

1/4" MULTI-SOCKET WRENCH

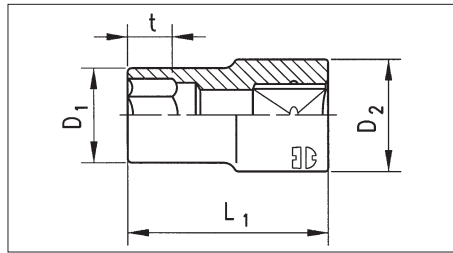

- Design: chrome-plated, polished
- Drive: 1/4" square drive
- Output: Bi-hexagon, multi profile
- Geometry: short

Multi profile	Possible uses				L1	D1	D2	t	Art. no.	PU/Qty.
	Hexagon/ bi-hexagon	Hex.	TX head	Square						
mm	mm	Inch	TX	mm	mm	mm	mm	mm		
4	Size 4	5/32"	E 5	-	22	6.8	11.9	5	0713 113 04	1
5	Size 5	-	-	Size 4	22	8.1	11.9	5	0713 113 05	1
5.5	Size 5.5	7/32"	-	Size 4.5	22	8.7	11.9	5.5	0713 113 055	1
6	Size 6	-	E 8	Size 5	22	9.3	11.9	6	0713 113 06	1
7	Size 7	9/32"	-	-	22	10.8	11.9	6	0713 113 07	1
8	Size 8	5/16"	E 10	-	22	11.9	11.9	7	0713 113 08	1
9	Size 9	11/32"	-	-	22	13.4	13.4	7	0713 113 09	1
10	Size 10	3/8"	E 12	Size 8	22	14.5	14.5	10	0713 113 10	1
11	Size 11	7/16"	E 14	Size 9	22	15.9	15.9	10	0713 113 11	1
12	Size 12	15/32"	E 16	Size 10	22	16.9	16.9	10	0713 113 12	1
13	Size 13	1/2"	-	-	22	18.0	18.0	11	0713 113 13	1
14	Size 14	9/16"	E 18	-	22	19.6	19.6	11	0713 113 14	1



**1/4" multi-socket wrench assortment
33 pcs.**

Art. no. 0965 11 032

Supplied in a metal box and a high-quality foam insert with clamping effect.



Scope of delivery – 1/4" multi-socket wrench assortment

Designation	Tip	Length	Art. no.	PU/Qty.
Ratchet		138 mm	0712 014 0	1
Extension		100 mm	0713 118 104	1
Extension		150 mm	0713 118 106	1
Cardan joint		33 mm	0713 118 301	1
Screwdriver handle		216 mm	0613 430 311	1
Adapter with quick-change chuck		30 mm	0715 11 01	1
12 multi-socket wrenches 1 pc. each size 4-14		22 mm	0713 113 04 - 0713 113 14	1 of each
Bit PH 1		25 mm	0614 176 274	1
Bit PH 2			0614 176 461	1
Bit PH 3			0614 176 648	1
Bit slotted 0.8x5.5		25 mm	0614 175 653	1

Designation	Tip	Length	Art. no.	PU/Qty.
Hexagon socket bit Size 3		25 mm	0614 176 93	1
Hexagon socket bit Size 4		25 mm	0614 176 94	1
Hexagon socket bit Size 5		25 mm	0614 176 95	1
Hexagon socket bit Size 6		25 mm	0614 176 96	1
TX 10		25 mm	0614 311 0	1
TX 15		25 mm	0614 311 5	1
TX 20		25 mm	0614 312 0	1
TX 25		25 mm	0614 312 5	1
TX 27		25 mm	0614 312 7	1
TX 30		25 mm	0614 313 0	1
TX 40		25 mm	0614 314 0	1
Metal box, size 1		-	225x125x35 mm	0955 715 1
Foam insert	-	220x105x30 mm	0955 11 32	1