

1/2" MULTI-SOCKET WRENCH

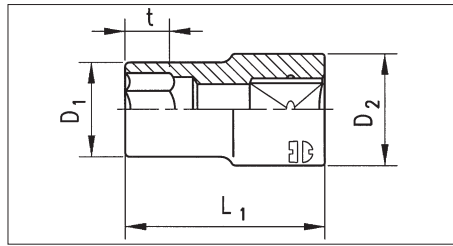

- Design: chrome-plated, polished
- Drive: 1/2"
- Output: 12-pt., multiA-profile
- Geometry: short

Multi-profile in mm	Possible Uses				L1 in mm	D1 in mm	D2 in mm	t in mm	Art. No.	P. Qty.
	6-pt./12-pt. in mm	6-pt. in inches	Outer TX TX	4-pt. in mm						
10	10 mm	3/8"	E 12	8 mm	36	15.5	23.0	9	0712 134 10	1
11	11 mm	7/16"	E 14	9 mm	36	16.7	23.0	10	0712 134 11	1
12	12 mm	1/2"	E 16	10 mm	36	18.0	23.0	11	0712 134 12	1
13	13 mm	1/2"	-	-	36	19.2	23.0	11	0712 134 13	1
14	14 mm	9/16"	E 18	-	36	20.5	23.0	13	0712 134 14	1
15	15 mm	19/32"	-	12 mm	36	21.7	23.0	13	0712 134 15	1
16	16 mm	5/8"	E 20	13 mm	36	23.0	23.0	13	0712 134 16	1
17	17 mm	-	-	14 mm	36	24.2	23.2	13	0712 134 17	1
18	18 mm	-	E 22	-	36	25.5	23.5	14	0712 134 18	1
19	19 mm	3/4"	E 24	-	36	26.7	24.7	14	0712 134 19	1
20	20	25/32"	-	16 mm	36	28.0	25.5	14	0712 134 20	1
21	21 mm	13/16"	E 26	17 mm	38	29.2	26.0	14	0712 134 21	1
22	22 mm	7/8"	E 28	18 mm	38	30.5	26.5	16	0712 134 22	1
24	24 mm	15/16"	E 30	19 mm	38	33.0	29.0	18	0712 134 24	1
26	26 mm	-	E 32	21 mm	38	35.5	31.5	18	0712 134 26	1
27	27 mm	1 1/16"	E 34	22 mm	44	36.7	32.2	20	0712 134 27	1
28	28 mm	1 1/8"	E 36	23 mm	44	38.0	33.5	20	0712 134 28	1
30	30 mm	1 3/16"	E 38	24 mm	44	40.5	36.0	22	0712 134 30	1
32	32 mm	1 1/4"	E 40	26 mm	44	43.0	38.1	24	0712 134 32	1



1/2" Multi-Socket Wrench Assortment 23-piece

Art. No. 0965 13 023

Supplied in a metal box and a high-quality foam insert with clamping effect.

Delivery scope – 1/2" Multi-Socket Wrench Assortment

Designation	Tip	Length	Art. No.	P. Qty.
Ratchet	□	250 mm	0712 012 0	1
Extension		125 mm	0712 138 105	1
Extension		250 mm	0712 138 110	1
Cardan joint		70 mm	0712 138 301	1
19 multi-socket wrench 1 pc. each 10-32 mm	⊙	36-44 mm	0712 134 10 - 0712 134 32	1
Metal box, size 3	-	405x160x50 mm	0955 715 3	1
Foam insert	-	400x150x40 mm	0955 13 230	1