

1/4" Universal Joint with Clamping Device

Finish: chrome-plated, matte

Input drive: 1/4", ball groove

Output drive: 6 points, metric sizes, double ball stop and flat spiral spring ring, Powerdriv

Application: secure retention of screws or nuts, even flat head or A2 screws, for working in confined spaces

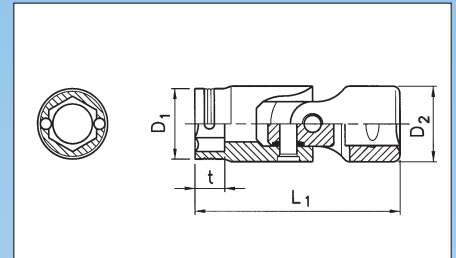

mm	L ₁ mm	D ₁ mm	D ₂ mm	t mm	Art. No.	
8	30	12.3	13	5	0713 111 08	1
10	31	14.5	13	6	0713 111 10	
12	32	16.8	13	7	0713 111 12	
13	33	18	13	8	0713 111 13	

1/4" Socket for Outer TX Screws

Finish: chrome-plated, polished/matte

Input drive: 1/4", ball groove

Output drive: outer TX

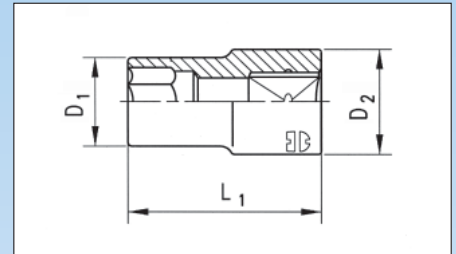

mm	L ₁ mm	D ₁ mm	D ₂ mm	Art. No.	
3.86	4	22	5.4	0715 112 04	1
4.75	5	22	6.7	0715 112 05	
5.74	6	22	7.7	0715 112 06	
6.22	7	22	8.3	0715 112 07	
7.52	8	22	9.6	0715 112 08	
9.43	10	22	11.3	0715 112 10	
10.08	11	22	12	0715 112 11	

1/4" Socket for Inner TX Screws

Finish: chrome-plated, polished/matte

Input drive: 1/4", ball groove

Output drive: inner TX

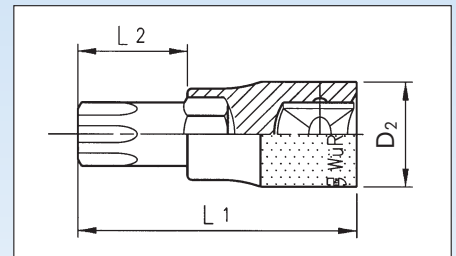

mm	L ₁ mm	L ₂ mm	D ₂ mm	Art. No.	
2,30	8	32	12	0715 113 08	1
2,48	9	32	12	0715 113 09	
2,72	10	32	12	0715 113 10	
3,26	15	32	12	0715 113 15	
3,84	20	32	12	0715 113 20	
4,40	25	32	12	0715 113 25	
4,96	27	32	12	0715 113 27	
5,49	30	32	12	0715 113 30	
6,60	40	32	12	0715 113 40	