

1/4" RATCHET – THE RIGHT SOLUTION FOR ANY APPLICATION!



Top quality, tested by the German TÜV SÜD



Product Service

The ZEBRA® (1/2" and 1/4") ratchets are the test winners among all fine-toothed ratchets.

The test: 8 ratchets each in the sizes 1/4" and 1/2" of the most important models of 16 manufacturers were tested for over a thousand cycles under the supervision and with the assistance of the German TÜV SÜD Product Service. The test report is available from Adolf Würth GmbH & Co. KG.



WÜRTH-Reversible ratchet



reddot design award honourable mention 2011



Rotary-disk switch-over

Compact, slim head with fine toothing!

Fine toothing with 72 teeth – 5° rotating angle

1. Simple reversing of clockwise and counterclockwise rotation with rotary disk
2. Chamfer on square – Easier removal of socket wrench inserts
3. Offset ratchet body for more clearance for gripping

Lever reversal

Rugged ratchet with convenient ejector!

Coarse toothing with 48 teeth – 7.5° rotating angle

1. Fast, simple reversing of clockwise and counterclockwise rotation with lever
2. Safety lock with quick ejector – locked
3. Safety lock with quick ejector – unlocked
4. Low-lying, protected reversing lever and offset ratchet body for more clearance for gripping

Drive	Length	Standard	Version	Handle
6.3-1.4"	135 mm	DIN 3122, ISO 3315	Chrome-plated	2-component handle

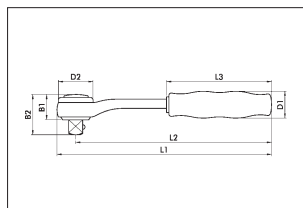
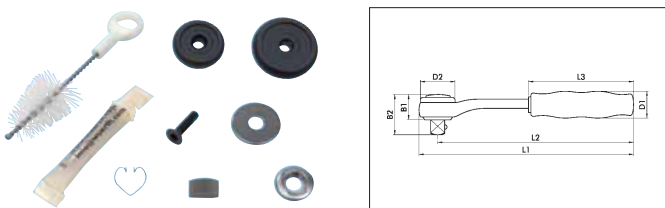

L1	L2	L3	B1	B2	D1	D2	Art. No.	P. Qty.
135	125	66	19	28	16	24	0712 014 0	1
Maintenance set							0712 001	1

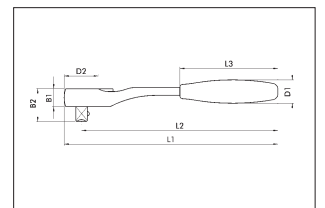
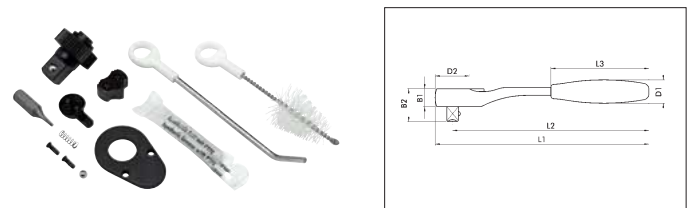

L1	L2	L3	B1	B2	D1	D2	Art. No.	P. Qty.
135	125	62	13	22	17	24	0712 014 01	1
Maintenance set							0712 000 14	1