

1/2" Extensions

Standard: DIN 3123, ISO 3316
 Model: Chrome-plated
 Drive: 1/2", ball catch groove
 Tip: 1/2"

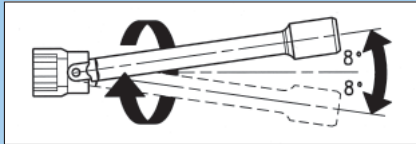

¹ Angled extension
 Use:
 Angled movement up to 8° possible
 → Working in hard-to-reach places.

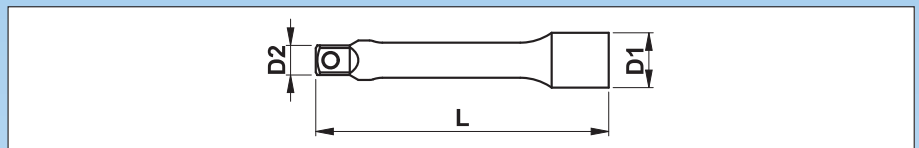

D1 mm	D2 mm	L mm	L	Art. No.	
23	15	53	2"	0712 138 102	1/10
23	15	75	3"	0712 138 103	
23	15	125	5"	0712 138 105	
23	15	250	10"	0712 138 110	
23	17	457	18"	0712 138 118	
23	15.5	75	3"	0715 13 40 ¹	1
23	15.5	150	6"	0715 13 41 ¹	

1/2" Cardan Joint

Standard: DIN 3123, ISO 3316
 Model: Chrome-plated
 Drive: 1/2", ball catch groove
 Tip: 1/2"
 Joint: braked

→ Remains in specified position.

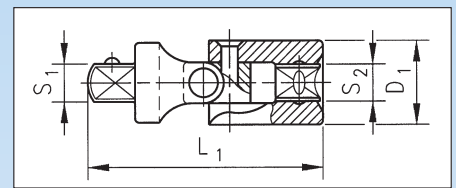
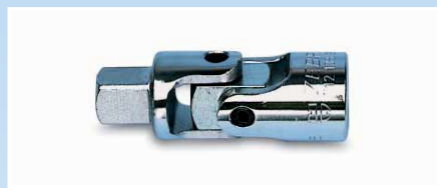

S1	S2	D1 mm	L1 mm	Art. No.	
1/2"	1/2"	25	70	0712 138 301	1/10

1/2" Adapter with Quick-Change Chuck

Drive: Inner square, DIN 3121
 for use with ratchet or other square drive
 With hole for locking pin and O-ring groove
 Tip: 1/4" or 5/16" hexagon drive, DIN 3126

Uses: Universal mounting of 1/4" bits or 5/16" bits

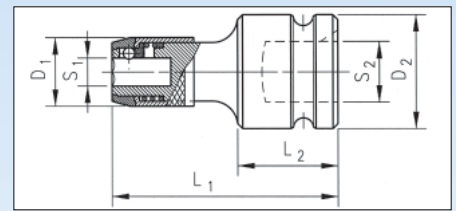

S1	S2	L1 mm	L2 mm	D1 mm	D2 mm	Art. No.	
1/4"	1/2"	50	22	15	25	0715 13 01	1
5/16"	1/2"	50	22	20	25	0715 13 02	

Connection Piece

Standard: DIN 3123, ISO 3316
 Model: Chrome-plated
 Drive: 1/2" Inner square
 Tip: 3/8" or 3/4" outer square
 Use: Adapter for 3/8" or 3/4" socket wrench inserts

¹ also with 22 mm wrench aid

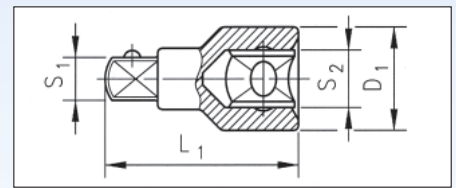

S1	S2	D1 mm	L1 mm	Art. No.	
3/8"	1/2"	23	38	0712 138 401	1/10
3/4"	1/2"	25	44	0712 138 402	
3/8"	1/2"	25	600	0715 12 171 ¹	