

## CONNECTION PIECE

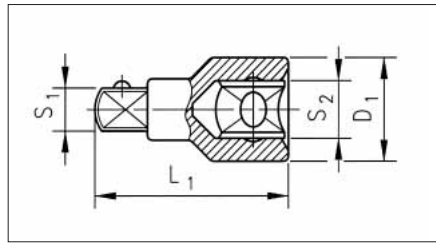

- Standard: DIN 3123, ISO 3316
- Design: chrome-plated, matt
- Drive: 1" square socket
- Output: 3/4" square head
- Application: Adapter on 3/4" socket wrench inserts

S1	S1	D1 in mm	L1 in mm	Art. No.	P. Qty.
3/4"	1"	48	66	0715 141 10	1

## 1/4" SOCKET WRENCH INSERTS

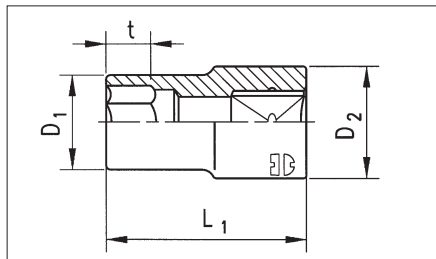

### Metric, bi-hexagonal

- Standard: DIN 3124, ISO 2725
- Version: Chrome-plated, ground/matte
- Drive: 1", locking pin
- Tip: Bi-hex., metric
- Geometry: Short

in mm	L1 in mm	D1 in mm	D2 in mm	t in mm	Art. No.	P. Qty.
36	65	52	45	28	0714 151 136	1
38	65	54	45	30	0714 151 138	1
41	70	57	45	32	0714 151 141	1
46	75	65	50	34	0714 151 146	1
50	75	70	55	34	0714 151 150	1
55	80	76	57	40	0714 151 155	1
60	84	82	57	42	0714 151 160	1
65	87	88	57	44	0714 151 165	1
70	93	94	68	48	0714 151 170	1
75	97	100	68	52	0714 151 175	1
80	103	105	68	54	0714 151 180	1

## 1" SOCKET WRENCH ASSORTMENT



### Metric

#### Metal assortment box

#### Content: 12 pieces

1 reversible ratchet, 1 slide rod, 1 extension, 200 mm  
1 extension, 400 mm, 8 socket wrench inserts, size  
36, 41, 46, 50, 55, 60, 65, 70 mm

Art. No. 0965 15 12

P. Qty. 1