

3/4" RATCHET

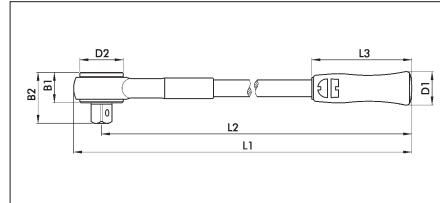
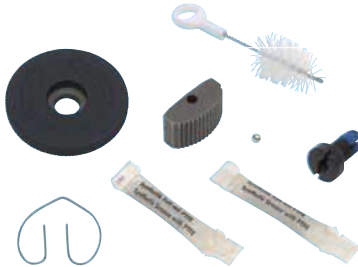

L1 mm	L2 mm	L3 mm	B1 mm	B2 mm	D1 mm	D2 mm	Art. no.	PU/Qty.
530	500	120	37	62	39	52	0715 141 01	1
Maintenance set*							0715 141 0	1

* Regular maintenance extends the service life.

3/4" ratchet

Technical data:

- Drive: 20 = 3/4"
- Standard: DIN 3122, ISO 315
- Head: finely toothed, 72 teeth, 5° rotating angle
- Design: chrome-plated, with two-component handle

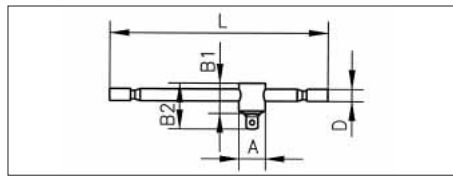

L mm	B1 mm	B2 mm	D in mm	A in mm	Art. no.	PU/Qty.
450	38	60	20	37.5	0715 141 04	1

3/4" t-handle

- Standard: DIN 3122, ISO 3315
- Sliding handle: with ball lock
- Design: chrome-plated
- Application: T or L-handle

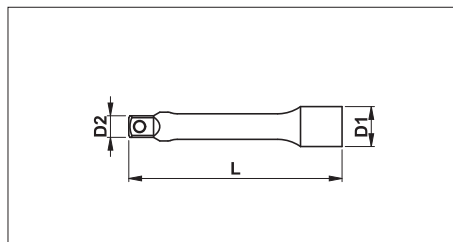

D1 mm	D2 mm	L mm	L mm	Art. no.	PU/Qty.
35.5	25	200	8"	0715 141 05	1
35.5	25	400	18"	0715 141 06	1

3/4" extensions

- Standard: DIN 3123, ISO 3316
- Design: chrome-plated
- Drive: 3/4", locking pin
- Output: 3/4", locking pin



S1	S1	D1 mm	L1 mm	Art. no.	PU/Qty.
3/4"	3/4"	40	109	0715 141 07	1

3/4" cardan joint

- Standard: DIN 3123, ISO 3316
- Design: chrome-plated, polished
- Drive: 3/4", locking pin
- Output: 3/4", locking pin
- Joint: braked
 - Remains in the preset position for work on hard-to-reach places