

BLIND RIVET, ROUND PAN HEAD DIN EN ISO 15977

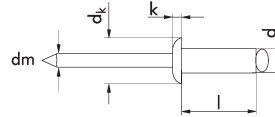

**Sleeve: Al-Mg aluminium 2.5;
mandrel: Galvanised steel,
blue passivated (A2K)**

Proof of Performance (Pub)

Tensile forces and shear forces in line with ISO 15977 class L

Material of the sleeve	Aluminium
Material of the mandrel	Steel
Surface of the sleeve	Plain
Surface of the mandrel	Galvanised

Nominal diameter (d ₁)	Length (l ₁)	Head diameter (d _k)	Screw-head height (k ₁)	Drill hole diameter	Min./max. clamping range	Mandrel diameter (d _m)	Shear-fracture load	Tensile fracture load	Nominal diameter x length (Ø d x l)	Art. No.	P. Qty.
2.4 mm	4.0 mm	5.0 mm	0.7 mm	2.5 mm	0.5-2.0 mm	1.45 mm	315 N	355 N	2.4 x 4.0 mm	5141 524 4	1000
2.4 mm	6.0 mm	5.0 mm	0.7 mm	2.5 mm	2.0-4.0 mm	1.45 mm	315 N	355 N	2.4 x 6.0 mm	5141 524 6	1000
2.4 mm	8.0 mm	5.0 mm	0.7 mm	2.5 mm	4.0-6.0 mm	1.45 mm	315 N	355 N	2.4 x 8.0 mm	5141 524 8	1000
2.4 mm	10.0 mm	5.0 mm	0.7 mm	2.5 mm	6.0-8.0 mm	1.45 mm	315 N	355 N	2.4 x 10.0 mm	5141 524 10	1000
3.0 mm	4.0 mm	6.5 mm	0.8 mm	3.1 mm	0.5-1.5 mm	1.75 mm	620 N	810 N	3.0 x 4.0 mm	5141 530 4	500
3.0 mm	6.0 mm	6.5 mm	0.8 mm	3.1 mm	1.5-3.5 mm	1.75 mm	620 N	810 N	3.0 x 6.0 mm	5141 530 6	500
3.0 mm	8.0 mm	6.5 mm	0.8 mm	3.1 mm	3.5-5.0 mm	1.75 mm	620 N	810 N	3.0 x 8.0 mm	5141 530 8	500
3.0 mm	10 mm	6.5 mm	0.8 mm	3.1 mm	5.0-7.0 mm	1.75 mm	620 N	810 N	3.0 x 10 mm	5141 531 0	500
3.0 mm	12 mm	6.5 mm	0.8 mm	3.1 mm	7.0-9.0 mm	1.75 mm	620 N	810 N	3.0 x 12 mm	5141 531 2	500
3.0 mm	14 mm	6.5 mm	0.8 mm	3.1 mm	9.0-11.0 mm	1.75 mm	620 N	810 N	3.0 x 14 mm	5141 531 4	500
3.0 mm	16 mm	6.5 mm	0.8 mm	3.1 mm	11.0-13.0 mm	1.75 mm	620 N	810 N	3.0 x 16 mm	5141 531 6	500
3.2 mm	4 mm	6.5 mm	0.8 mm	3.3 mm	0.5-1.5 mm	1.75 mm	760 N	980 N	3.2 x 4 mm	5141 532 4	500
3.2 mm	6 mm	6.5 mm	0.8 mm	3.3 mm	1.5-3.5 mm	1.75 mm	760 N	980 N	3.2 x 6 mm	5141 532 6	500
3.2 mm	8 mm	6.5 mm	0.8 mm	3.3 mm	3.5-5.0 mm	1.75 mm	760 N	980 N	3.2 x 8 mm	5141 532 8	500
3.2 mm	10 mm	6.5 mm	0.8 mm	3.3 mm	5.0-7.0 mm	1.75 mm	760 N	980 N	3.2 x 10 mm	5141 532 10	500
3.2 mm	12 mm	6.5 mm	0.8 mm	3.3 mm	7.0-9.0 mm	1.75 mm	760 N	980 N	3.2 x 12 mm	5141 532 12	500
3.2 mm	14 mm	6.5 mm	0.8 mm	3.3 mm	9.0-11.0 mm	1.75 mm	760 N	980 N	3.2 x 14 mm	5141 532 14	500
3.2 mm	16 mm	6.5 mm	0.8 mm	3.3 mm	11.0-13.0 mm	1.75 mm	760 N	980 N	3.2 x 16 mm	5141 532 16	500
3.2 mm	18 mm	6.5 mm	0.8 mm	3.3 mm	13.0-15.0 mm	1.75 mm	760 N	980 N	3.2 x 18 mm	5141 532 18	500
3.2 mm	20 mm	6.5 mm	0.8 mm	3.3 mm	15.0-17.0 mm	1.75 mm	760 N	980 N	3.2 x 20 mm	5141 532 20	500
4.0 mm	6 mm	8.0 mm	1.0 mm	4.1 mm	1.5-3.0 mm	2.10 mm	1200 N	1600 N	4.0 x 6 mm	5141 540 6	500
4.0 mm	8 mm	8.0 mm	1.0 mm	4.1 mm	3.0-5.0 mm	2.10 mm	1200 N	1600 N	4.0 x 8 mm	5141 540 8	500
4.0 mm	10 mm	8.0 mm	1.0 mm	4.1 mm	5.0-6.5 mm	2.10 mm	1200 N	1600 N	4.0 x 10 mm	5141 540 10	500
4.0 mm	12 mm	8.0 mm	1.0 mm	4.1 mm	6.5-8.5 mm	2.10 mm	1200 N	1600 N	4.0 x 12 mm	5141 540 12	500
4.0 mm	14 mm	8.0 mm	1.0 mm	4.1 mm	8.5-10.5 mm	2.10 mm	1200 N	1600 N	4.0 x 14 mm	5141 540 14	500
4.0 mm	16 mm	8.0 mm	1.0 mm	4.1 mm	10.5-12.5 mm	2.10 mm	1200 N	1600 N	4.0 x 16 mm	5141 540 16	500
4.0 mm	18 mm	8.0 mm	1.0 mm	4.1 mm	12.5-14.5 mm	2.10 mm	1200 N	1600 N	4.0 x 18 mm	5141 540 18	500
4.0 mm	20 mm	8.0 mm	1.0 mm	4.1 mm	14.5-16.5 mm	2.10 mm	1200 N	1600 N	4.0 x 20 mm	5141 540 20	500
4.0 mm	23 mm	8.0 mm	1.0 mm	4.1 mm	16.5-19.0 mm	2.10 mm	1200 N	1600 N	4.0 x 23 mm	5141 540 23	500
4.0 mm	25 mm	8.0 mm	1.0 mm	4.1 mm	19.0-21.0 mm	2.10 mm	1200 N	1600 N	4.0 x 25 mm	5141 540 25	500
4.8 mm	6.0 mm	9.5 mm	1.1 mm	4.9 mm	1.5-2.5 mm	2.70 mm	1690 N	2230 N	4.8 x 6.0 mm	5141 548 6	500
4.8 mm	8.0 mm	9.5 mm	1.1 mm	4.9 mm	2.5-4.0 mm	2.70 mm	1690 N	2230 N	4.8 x 8.0 mm	5141 548 8	500
4.8 mm	10 mm	9.5 mm	1.1 mm	4.9 mm	4.0-6.0 mm	2.70 mm	1690 N	2230 N	4.8 x 10 mm	5141 548 10	500
4.8 mm	12 mm	9.5 mm	1.1 mm	4.9 mm	6.0-8.0 mm	2.70 mm	1690 N	2230 N	4.8 x 12 mm	5141 548 12	500
4.8 mm	14.0 mm	9.5 mm	1.1 mm	4.9 mm	8.0-10.0 mm	2.70 mm	1690 N	2230 N	4.8 x 14.0 mm	5141 548 14	500
4.8 mm	16.0 mm	9.5 mm	1.1 mm	4.9 mm	10.0-12.0 mm	2.70 mm	1690 N	2230 N	4.8 x 16.0 mm	5141 548 16	500
4.8 mm	18 mm	9.5 mm	1.1 mm	4.9 mm	12-14 mm	2.7 mm	1690 N	2230 N	4.8 x 18 mm	5141 548 18	250
4.8 mm	20.0 mm	9.5 mm	1.1 mm	4.9 mm	14.0-16.0 mm	2.70 mm	1690 N	2230 N	4.8 x 20.0 mm	5141 548 20	250
4.8 mm	22.0 mm	9.5 mm	1.1 mm	4.9 mm	16.0-18.0 mm	2.70 mm	1690 N	2230 N	4.8 x 22.0 mm	5141 548 22	250
4.8 mm	25.0 mm	9.5 mm	1.1 mm	4.9 mm	18.0-20.0 mm	2.70 mm	1690 N	2230 N	4.8 x 25.0 mm	5141 548 25	250