

1/2 INCH POWER EXTENSION

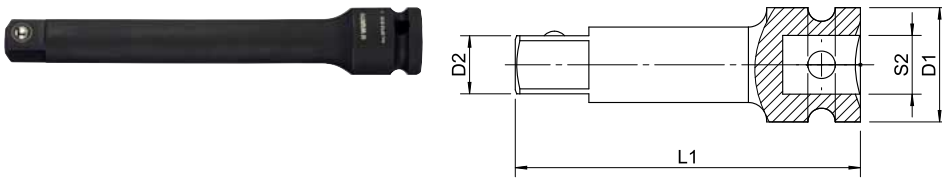

Drive (S2)	1/2 inch
Tip size (D2)	1/2 inch
Socket wrench external diameter (D1)	25 mm

Length (L1)	Art. No.	P. Qty.
75 mm	0714 13 22	1
150 mm	0714 13 23	1
250 mm	0714 13 235	1

1/2-inch square drive and ball lock

- Suitable for all standard compressed air and electric screwdrivers
- Standard: square drive according to DIN 3121
- Design: forged, burnished

1/2 INCH POWER CARDAN JOINT

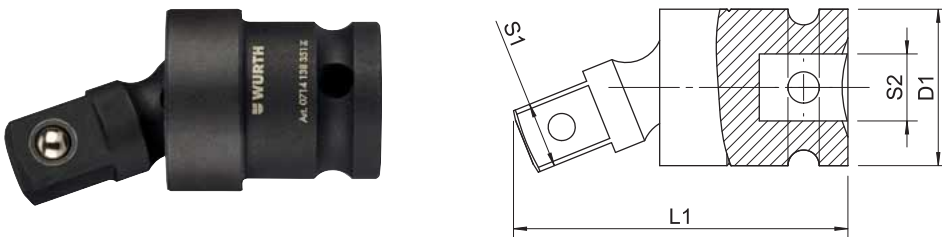

Art. No.	0714 138 351
P. Qty.	1
Drive (S2)	1/2 inch
Tip size (S1)	1/2 inch
Length (L1)	63 mm
Socket wrench external diameter (D1)	30 mm

1/2-inch square drive and ball lock

- Fits all conventional compressed air and electric drivers
- Standard: Square drive acc. to DIN 3121
- Design: forged, burnished

1/2" POWER CONNECTOR

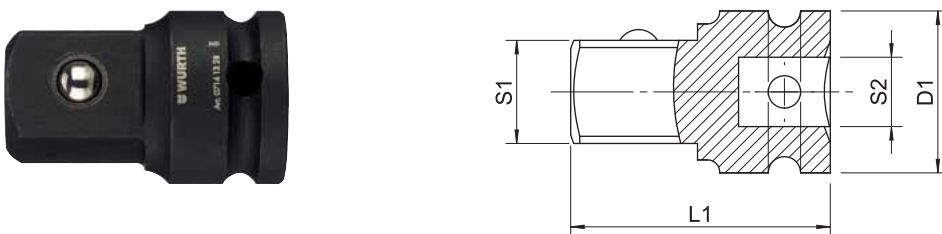

Art. No.	0714 13 28
P. Qty.	1
Drive (S2)	1/2 inch
Tip size (S1)	3/4 inch
Length (L1)	48 mm
Socket wrench external diameter (D1)	30 mm

3/4-inch square drive and ball lock

- Suitable for all standard compressed air and electric screwdrivers
- Standard: square drive according to DIN 3121
- Design: forged, burnished